

DRUTEX S.A.

MB-86N SI TILT & TURN WINDOW (HVHZ)(IMPACT)

GENERAL NOTES:

- THE PRODUCT SHOWN HEREIN IS DESIGNED AND MANUFACTURED TO COMPLY WITH THE CURRENT EDITION OF THE FLORIDA BUILDING CODE (FBC), **INCLUDING** HVHZ AND HAS BEEN EVALUATED ACCORDING TO THE FOLLOWING:
 - AAMA/WDMA/CSA 101/I.S.2/A440-17
 - TAS 201-94
 - TAS 202-94
 - TAS 203-94
 - ASTM E1886-19
 - ASTM E1996-20
- ADEQUACY OF THE EXISTING STRUCTURAL CONCRETE/MASONRY, 2X FRAMING, AND METAL FRAMING AS A MAIN WIND FORCE RESISTING SYSTEM CAPABLE OF WITHSTANDING AND TRANSFERRING APPLIED PRODUCT LOADS TO THE FOUNDATION IS THE RESPONSIBILITY OF THE ENGINEER OR ARCHITECT OF RECORD FOR THE PROJECT OF INSTALLATION.
- 1X AND 2X BUCKS (WHEN USED) SHALL BE DESIGNED AND ANCHORED TO PROPERLY TRANSFER ALL LOADS TO THE STRUCTURE. BUCK DESIGN AND INSTALLATION IS THE RESPONSIBILITY OF THE ENGINEER OR ARCHITECT OF RECORD FOR THE PROJECT OF INSTALLATION.
- INSTALL INDIVIDUAL INSTALLATION ANCHORS WITHIN A TOLERANCE OF ±1/4 INCH OF THE DEPICTED LOCATION IN THE ANCHOR LAYOUT DETAIL (I.E., WITHOUT CONSIDERATION OF TOLERANCES). TOLERANCES ARE NOT CUMULATIVE FROM ONE INSTALLATION ANCHOR TO THE NEXT.
- THE INSTALLATION DETAILS DESCRIBED HEREIN ARE GENERIC AND MAY NOT REFLECT ACTUAL CONDITIONS FOR A SPECIFIC SITE. IF SITE CONDITIONS CAUSE INSTALLATION TO DEVIATE FROM THE REQUIREMENTS DETAILED HEREIN, A LICENSED ENGINEER OR ARCHITECT SHALL PREPARE SITE SPECIFIC DOCUMENTS FOR USE WITH THIS DOCUMENT.
- APPROVED IMPACT PROTECTIVE SYSTEM **IS NOT REQUIRED** ON THIS PRODUCT IN AREAS REQUIRING IMPACT RESISTANCE.
- WINDOW FRAME MATERIAL: ALUMINUM 6063-T5
- GLASS MEETS THE REQUIREMENTS OF ASTM E1300 GLASS CHARTS. SEE SHEET 1 FOR GLAZING DETAIL.
- CUSTOM SIZES AVAILABLE UPON REQUEST. CUSTOM DESIGN PRESSURE WILL BE ASSIGNED EQUAL TO NEXT LARGER STANDARD SIZE.

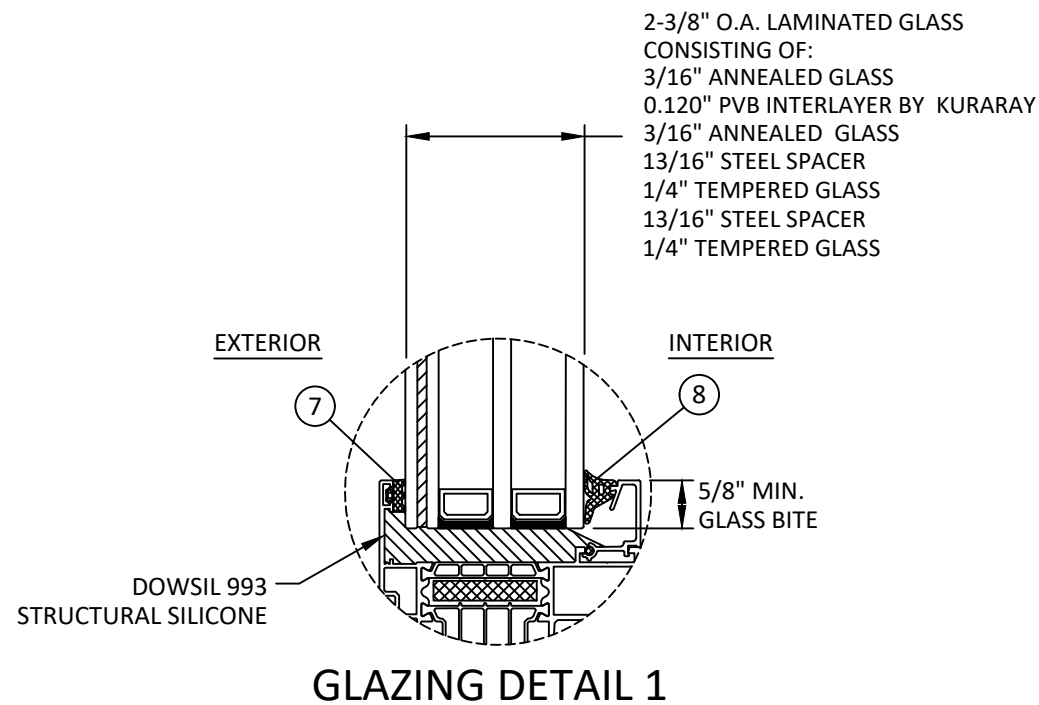

GLAZING NOTES:

- GLASS TYPE COMPLIES WITH ASTM E1300 REQUIREMENTS. PER THE FBC TEMPER AND SAFETY GLAZING REQUIREMENTS SHALL BE REVIEWED ON A SITE SPECIFIC BASIS.
- SETTING BLOCK DUROMETER HARDNESS OF 70-90 (SHORE A) AS REFERENCED IN FBC CHAPTER 24.
- SETTING BLOCKS TO BE LOCATED AT 1/4 SPAN LENGTH FOR GLASS WIDER THAN 36" AS PER FBC CHAPTER 24.
- D.L.O. AND DESIGN PRESSURES MAY NOT EXCEED MAX VALUES SHOWN HEREIN.

TABLE OF CONTENTS	
SHEET	SHEET DESCRIPTION
1	GENERAL NOTES AND GLAZING DETAIL
2	ELEVATION AND DESIGN PRESSURE TABLE
3	ANCHOR LAYOUTS
4	VERTICAL SECTION
5	HORIZONTAL SECTION
6	ANCHOR DETAILS AND INSTALLATION NOTES
7	BILL OF MATERIALS & COMPONENTS

DESIGN PRESSURE RATING (PSF)				
CONFIGURATION	WIDTH (IN.)	HEIGHT (IN.)	DESIGN PRESSURE	MISSILE IMPACT RATING
X	SEE TABLES ON SHEET 2			LARGE & SMALL MISSILE IMPACT



LEBORSKA 31, 77-100
BYTOW, POLAND
PH: +48-59-822-9101 FX: +48-59-822-9103

TITLE: MB-86N SI
TILT & TURN WINDOW
(HVHZ) (IMPACT)
GENERAL NOTES &
GLAZING DETAIL

PREPARED BY:
BUILDING DROPS, INC.
1900 NE MIAMI COURT, STE. 2-15
MIAMI, FL 33132
PH: (954) 399-8478
FAX: (954) 744-4738
WEB: www.buildingdrops.com



REMARKS	BY	DATE

THE INSTALLATION DETAILS DESCRIBED HEREIN ARE GENERIC AND MAY NOT REFLECT ACTUAL CONDITIONS FOR A SPECIFIC SITE. IF SITE CONDITIONS CAUSE INSTALLATION TO DEVIATE FROM THE REQUIREMENTS DETAILED HEREIN, A LICENSED ENGINEER OR ARCHITECT SHALL PREPARE SITE SPECIFIC DOCUMENTS FOR USE WITH THIS DOCUMENT.

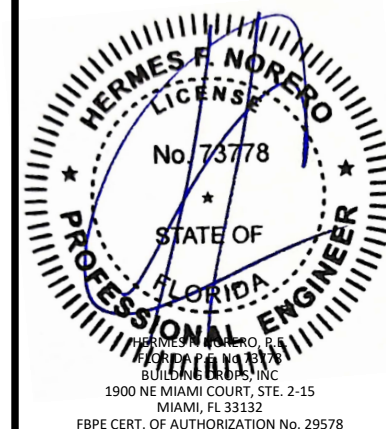

FL #:	FL46728
DATE:	03.19.24
DWG. BY:	FB
CHK. BY:	HFN
SCALE:	NTS
DWG. #:	DRU048
SHEET:	1
	OF 7

c:\Users\franciscobreno\building_drops, inc\building_drops_landing - common\projects\drutex, s.a\bc-23-0705.1 - bc_submittal - mb79n.si.mb86n.si.aluminum_systems\dwgs\mb86n\mb86n - &Archived\dr048.dwg 5/1/2024 3:52 PM

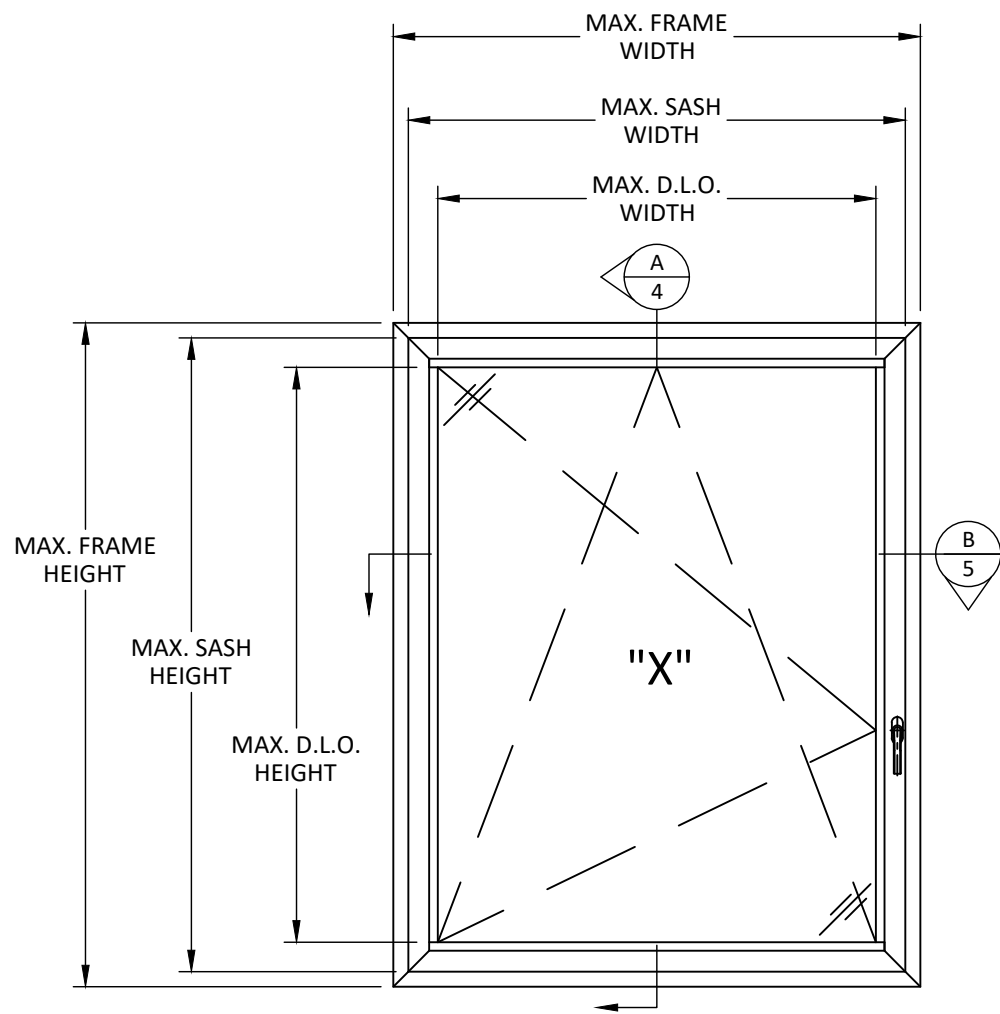

ELEVATION

SASH HEIGHT = FRAME HEIGHT - 3.00"
 SASH WIDTH = FRAME WIDTH - 3.00"
 D.L.O. HEIGHT = FRAME HEIGHT - 8.9375"
 D.L.O. WIDTH = FRAME WIDTH - 8.9375"

DESIGN PRESSURE TABLE (PSF)			
NOMINAL DIMS.		POS. (+)	NEG. (-)
FRAME WIDTH (IN.)	FRAME HEIGHT (IN.)		
18	36	70.0	70.0
24		70.0	70.0
30		70.0	70.0
36	42	70.0	70.0
18		70.0	70.0
24		70.0	70.0
30	48	70.0	70.0
36		70.0	70.0
42		70.0	70.0
18	54	70.0	70.0
24		70.0	70.0
30		70.0	70.0
36	60	70.0	70.0
42		70.0	70.0
48		70.0	70.0
54	66.9375	68.9	68.9
18		70.0	70.0
24		70.0	70.0
30	72	70.0	70.0
36		70.0	70.0
42		70.0	70.0
48	78	70.0	70.0
18		70.0	70.0
24		70.0	70.0
30	84	70.0	70.0
36		70.0	70.0
42		70.0	70.0
18	90	70.0	70.0
24		70.0	70.0
30		70.0	70.0
36	96	70.0	70.0
18		70.0	70.0
24		70.0	70.0
30	102	70.0	70.0
18		70.0	70.0
24		70.0	70.0
30	108	70.0	70.0
18		70.0	70.0
24		70.0	70.0
30	114	70.0	70.0
18		70.0	70.0
24		70.0	70.0
30	120	70.0	70.0
18		70.0	70.0
24		70.0	70.0
53.125		70.0	70.0

DESIGN PRESSURE TABLE (PSF)			
NOMINAL DIMS.		POS. (+)	NEG. (-)
FRAME WIDTH (IN.)	FRAME HEIGHT (IN.)		
18	72	70.0	70.0
24		70.0	70.0
30		70.0	70.0
36	78	70.0	70.0
42		70.0	70.0
48		70.0	70.0
18	84	70.0	70.0
24		70.0	70.0
30		70.0	70.0
36	90	70.0	70.0
42		70.0	70.0
48		70.0	70.0
18	96	70.0	70.0
24		70.0	70.0
30		70.0	70.0
36	102	70.0	70.0
18		70.0	70.0
24		70.0	70.0
30	108	70.0	70.0
18		70.0	70.0
24		70.0	70.0
30	114	70.0	70.0
18		70.0	70.0
24		70.0	70.0
30	120	70.0	70.0
18		70.0	70.0
24		70.0	70.0



LEBORSKA 31, 77-100
 BYTOW, POLAND
 PH: +48-59-822-9101 FX: +48-59-822-9103

TITLE: MB-86N SI
 TILT & TURN WINDOW
 (HVHZ) (IMPACT)
 ELEVATION & DESIGN
 PRESSURE TABLE

PREPARED BY:
BUILDING DROPS, INC.
 1900 NE MIAMI COURT, STE. 2-15
 MIAMI, FL 33132
 PH: (954)399-8478
 FAX: (954)744-4738
 WEB: www.buildingdrops.com



REMARKS	BY	DATE

THE INSTALLATION DETAILS DESCRIBED HEREIN ARE GENERIC AND MAY NOT REFLECT ACTUAL CONDITIONS FOR A SPECIFIC SITE. IF SITE CONDITIONS CAUSE INSTALLATION TO DEVIATE FROM THE REQUIREMENTS DETAILED HEREIN, A LICENSED ENGINEER OR ARCHITECT SHALL PREPARE SITE SPECIFIC DOCUMENTS FOR USE WITH THIS DOCUMENT.

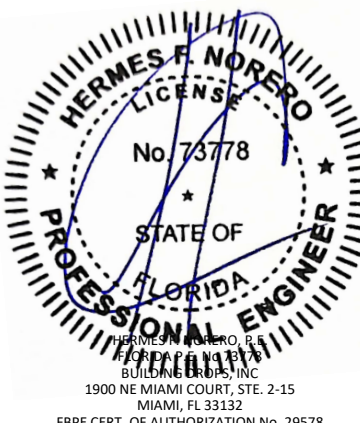

FL #: **FL46728**

DATE: **03.19.24**

DWG. BY: **FB** CHK. BY: **HFN**

SCALE: **NTS**

DWG. #: **DRU048**

SHEET: **2**
 OF 7

c:\Users\Franciscobreno\building_drops, inc\building_drops_landing - common\projects\drutex, s.a\bc-23-0705.1 - fbc_submittal - mb79n.si.mb86n.si.aluminum_systems\dwgs\mb86n\mb86n - fbc_submittal - mb79n.si.mb86n.si.aluminum_systems\dwgs\mb86n\mb86n.dwg 5/1/2024 3:52 PM

NOTE: TWO (2) INSTALLATION ANCHORS PER STRAP LOCATION.

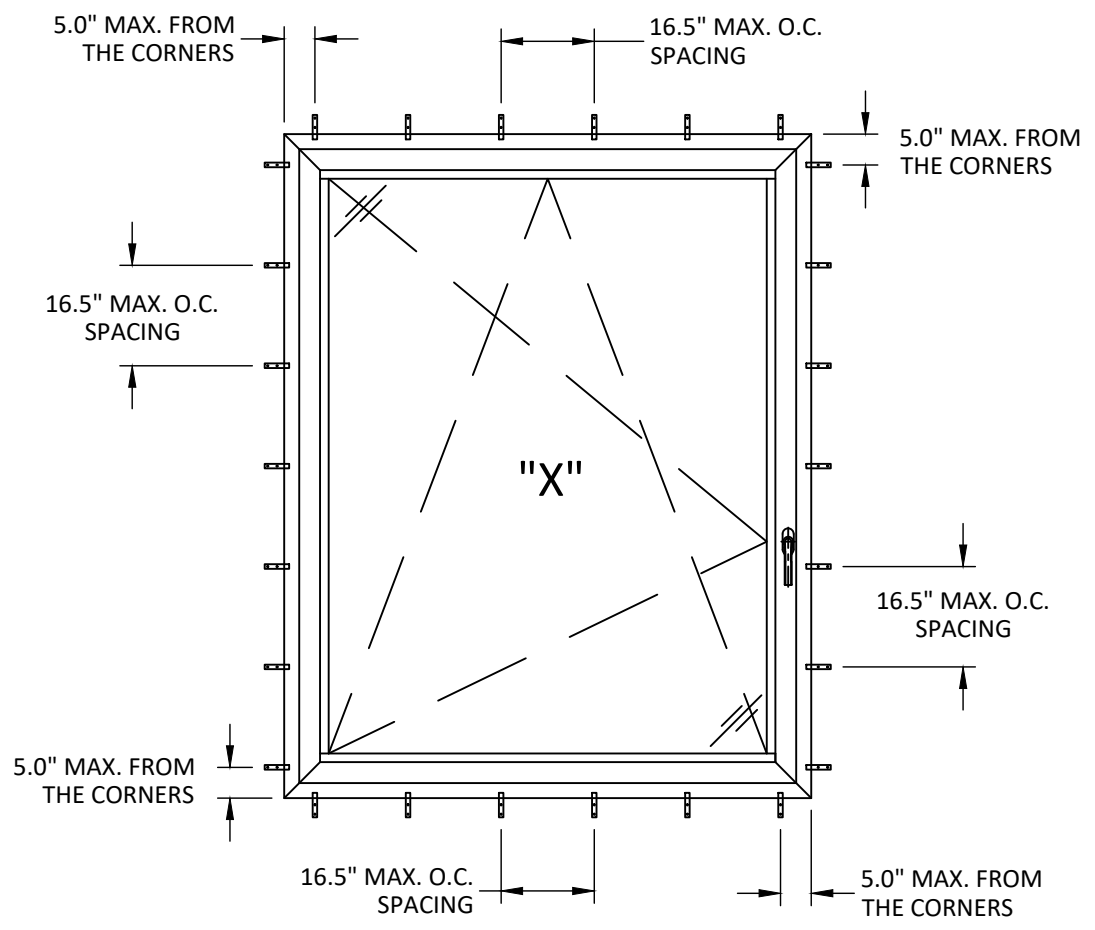

ANCHOR LAYOUT
STRAP INSTALLATION

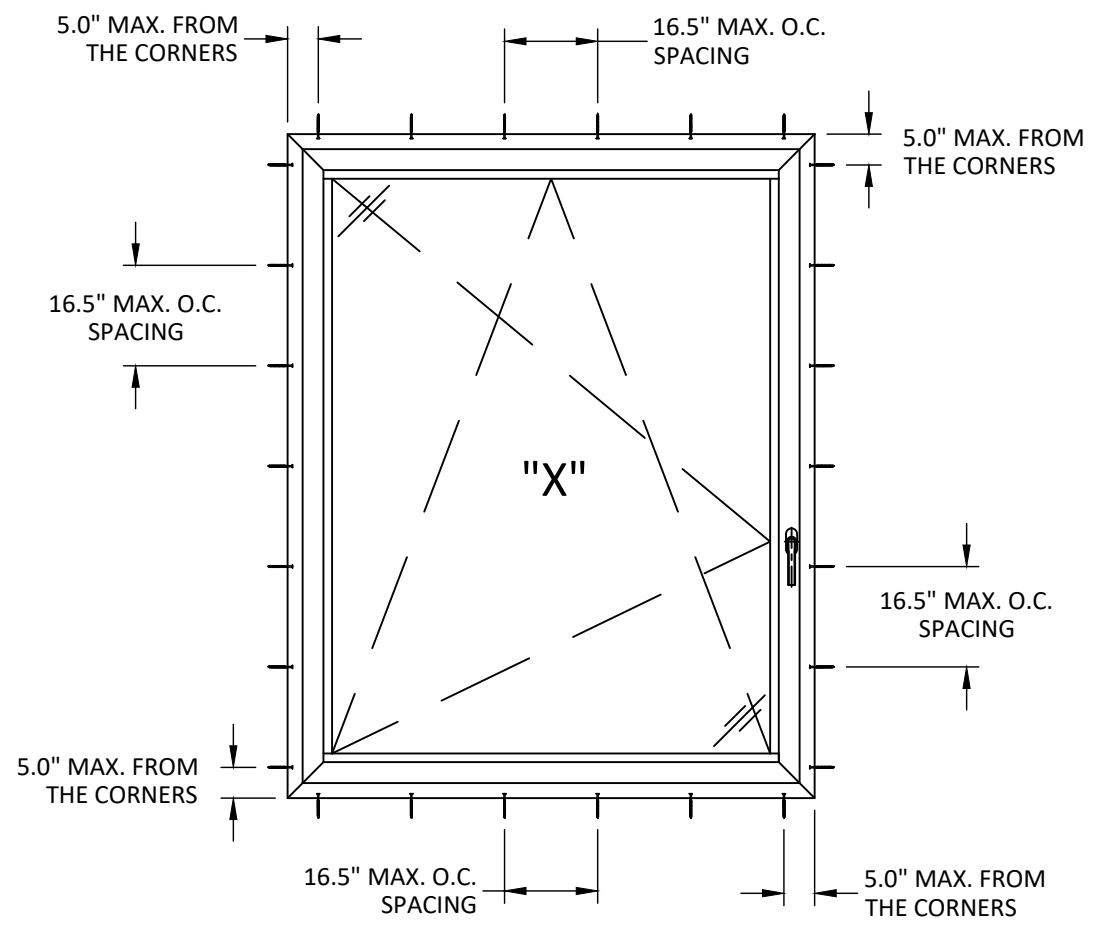

ANCHOR LAYOUT
THROUGH FRAME INSTALLATION



LEBORSKA 31, 77-100
BYTOW, POLAND
PH: +48-59-822-9101 FX: +48-59-822-9103

TITLE: MB-86N SI
TILT & TURN WINDOW
(HVHZ) (IMPACT)
ANCHOR LAYOUTS

PREPARED BY:
BUILDING DROPS, INC.
1900 NE MIAMI COURT, STE. 2-15
MIAMI, FL 33132
PH: (954)399-8478
FAX: (954)744-4738
WEB: www.buildingdrops.com



REMARKS	BY	DATE

THE INSTALLATION DETAILS DESCRIBED HEREIN ARE GENERIC AND MAY NOT REFLECT ACTUAL CONDITIONS FOR A SPECIFIC SITE. IF SITE CONDITIONS CAUSE INSTALLATION TO DEVIATE FROM THE REQUIREMENTS DETAILED HEREIN, A LICENSED ENGINEER OR ARCHITECT SHALL PREPARE SITE SPECIFIC DOCUMENTS FOR USE WITH THIS DOCUMENT.

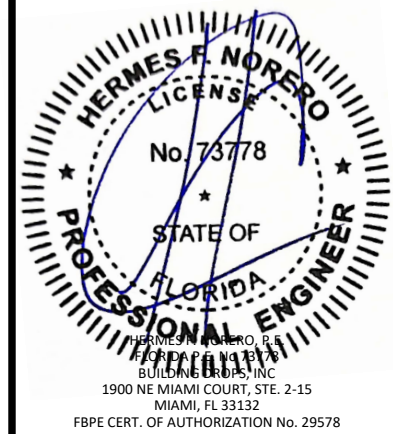

FL #: **FL46728**

DATE: **03.19.24**

DWG. BY: **FB** CHK. BY: **HFN**

SCALE: **NTS**

DWG. #: **DRU048**

SHEET:
3
OF 7

c:\Users\franciscobreno\building_drops, inc\building_drops_landing - common\projects\drutex, s.a\fb-23-0705.1 - fb_submittal - mb79n.si.mb86n.si.aluminum_systems\dwgs\mb86n.si\aluminum_systems\dwgs\mb86n.si\mb86n.si.dwg 5/1/2024 3:52 PM

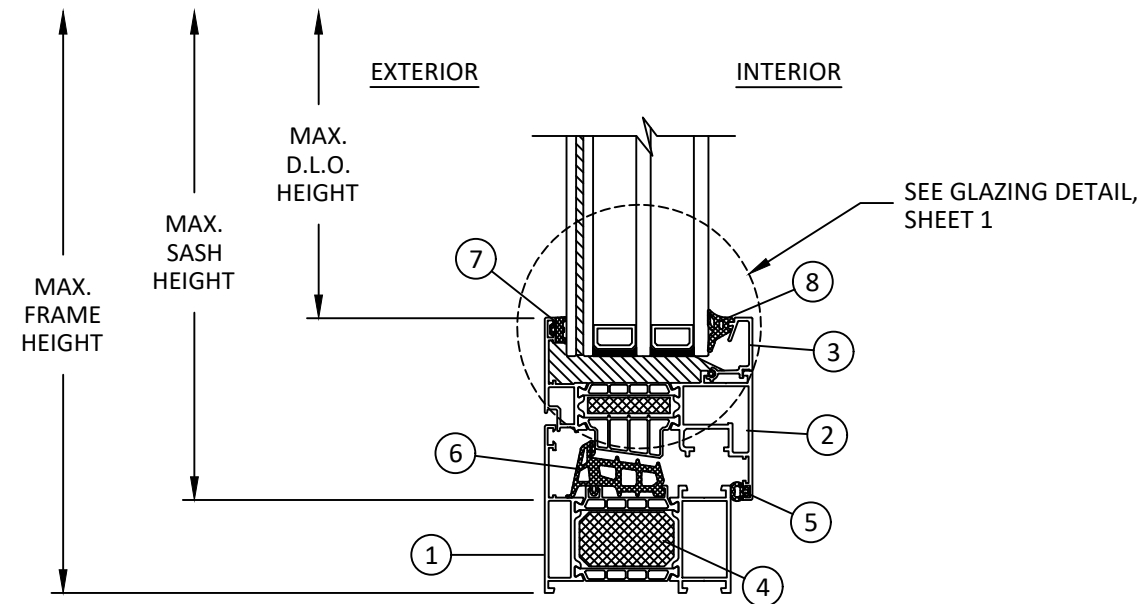
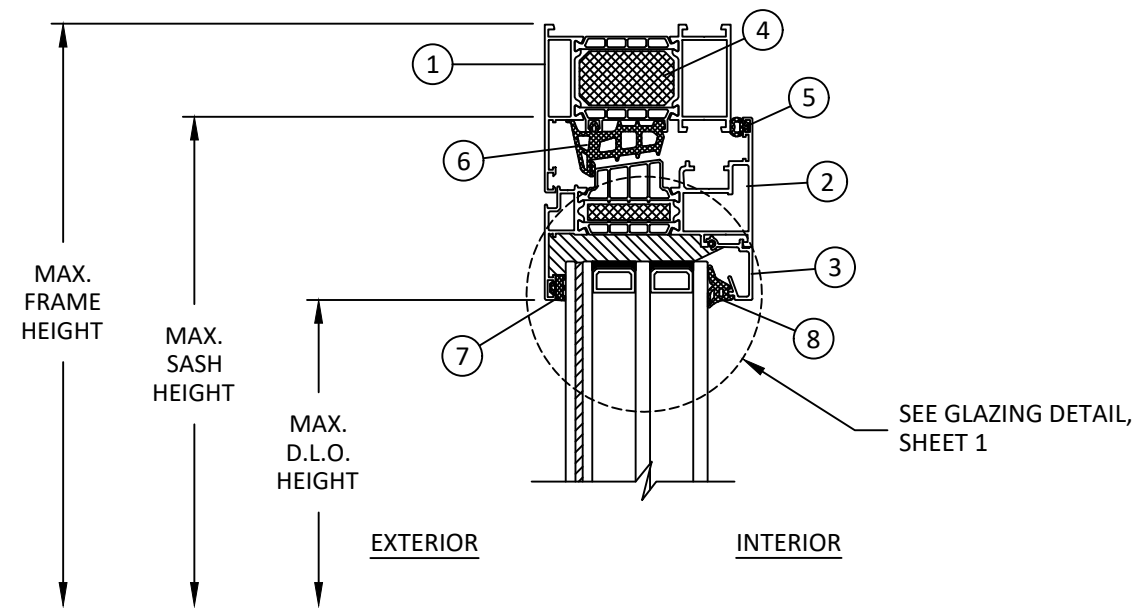

A
4 VERTICAL SECTION



LEBORSKA 31, 77-100
BYTOW, POLAND
PH: +48-59-822-9101 FX: +48-59-822-9103

TITLE: MB-86N SI
TILT & TURN WINDOW
(HYHZ) (IMPACT)
VERTICAL SECTION

PREPARED BY:
BUILDING DROPS, INC.
1900 NE MIAMI COURT, STE. 2-15
MIAMI, FL 33132
PH: (954) 399-8478
FAX: (954) 744-4738
WEB: www.buildingdrops.com

REMARKS	BY	DATE

THE INSTALLATION DETAILS DESCRIBED HEREIN ARE GENERIC AND MAY NOT REFLECT ACTUAL CONDITIONS FOR A SPECIFIC SITE. IF SITE CONDITIONS CAUSE INSTALLATION TO DEVIATE FROM THE REQUIREMENTS DETAILED HEREIN, A LICENSED ENGINEER OR ARCHITECT SHALL PREPARE SITE SPECIFIC DOCUMENTS FOR USE WITH THIS DOCUMENT.

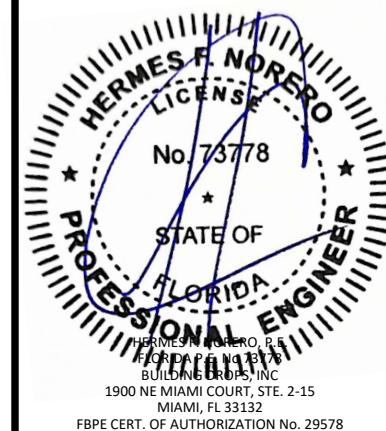

FL #:	FL46728
DATE:	03.19.24
DWG. BY:	FB
CHK. BY:	HFN
SCALE:	NTS
DWG. #:	DRU048
SHEET:	4

c:\users\franciscobreno\building_drops, inc\building_drops_landing - common\projects\drutex, s.a\fb-23-0705.1 - fb- submittal - mb79n.si.mbb8n.si.aluminum_systems\dwgs\mb86n\mb86n - fb\archive\dr048.dwg 5/1/2024 3:52 PM

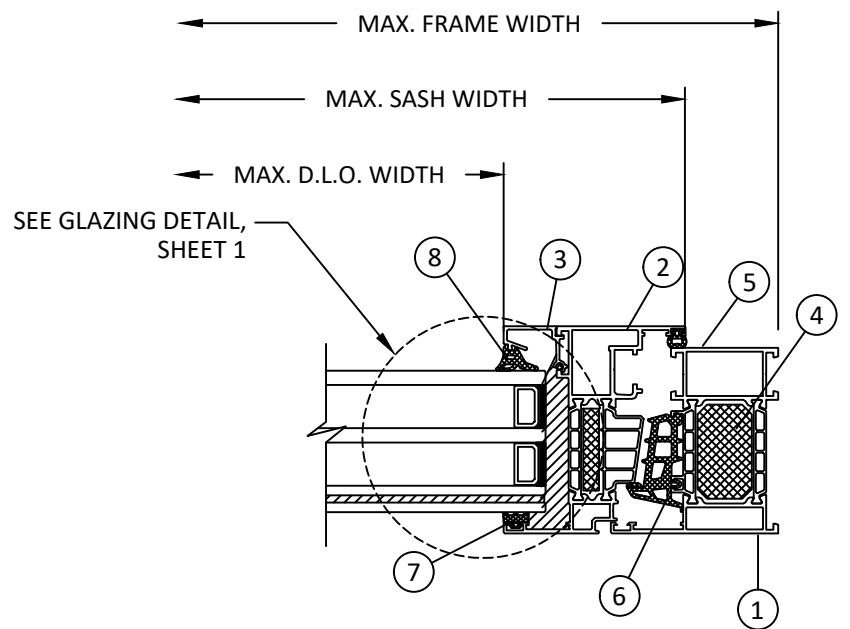
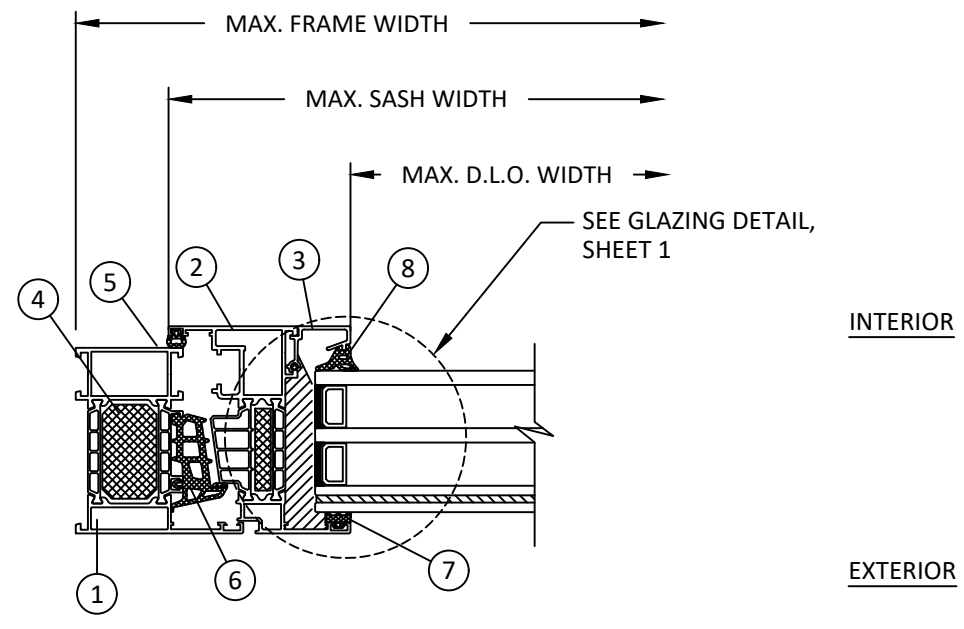

B
5 HORIZONTAL SECTION



LEBORSKA 31, 77-100
BYTOW, POLAND
PH: +48-59-822-9101 FX: +48-59-822-9103

TITLE: MB-86N SI
TILT & TURN WINDOW
(HVHZ) (IMPACT)
HORIZONTAL SECTION

PREPARED BY:
BUILDING DROPS, INC.
1900 NE MIAMI COURT, STE. 2-15
MIAMI, FL 33132
PH: (954)399-8478
FAX: (954)744-4738
WEB: www.buildingdrops.com



REMARKS	BY	DATE

THE INSTALLATION DETAILS DESCRIBED HEREIN ARE GENERIC AND MAY NOT REFLECT ACTUAL CONDITIONS FOR A SPECIFIC SITE. IF SITE CONDITIONS CAUSE INSTALLATION TO DEVIATE FROM THE REQUIREMENTS DETAILED HEREIN, A LICENSED ENGINEER OR ARCHITECT SHALL PREPARE SITE SPECIFIC DOCUMENTS FOR USE WITH THIS DOCUMENT.

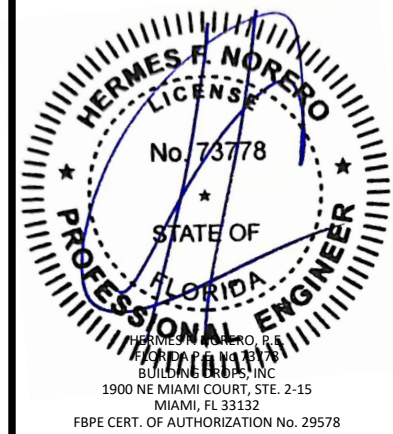

FL #: **FL46728**

DATE: **03.19.24**

DWG. BY: **FB** CHK. BY: **HFN**

SCALE: **NTS**

DWG. #: **DRU048**

SHEET:
5
OF 7

5/1/2024 3:52 PM
c:\users\franciscobriceno\building_drops, inc\building_drops, inc\projects\drutex, s.a\bc-23-0705.1 - bc_submittal - mb79n.si.mb86n.si.aluminum_systems\dwg\mb86n.mb86n - 181archive\dr048.dwg

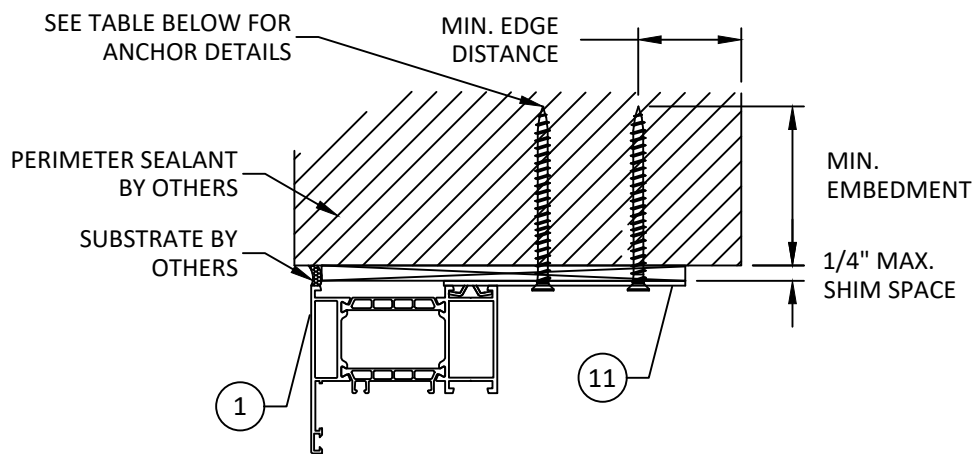

EXTERIOR INTERIOR
A
6 VERTICAL SECTION
 HEAD - STRAP

NOTE: SILL & JAMB SIMILAR

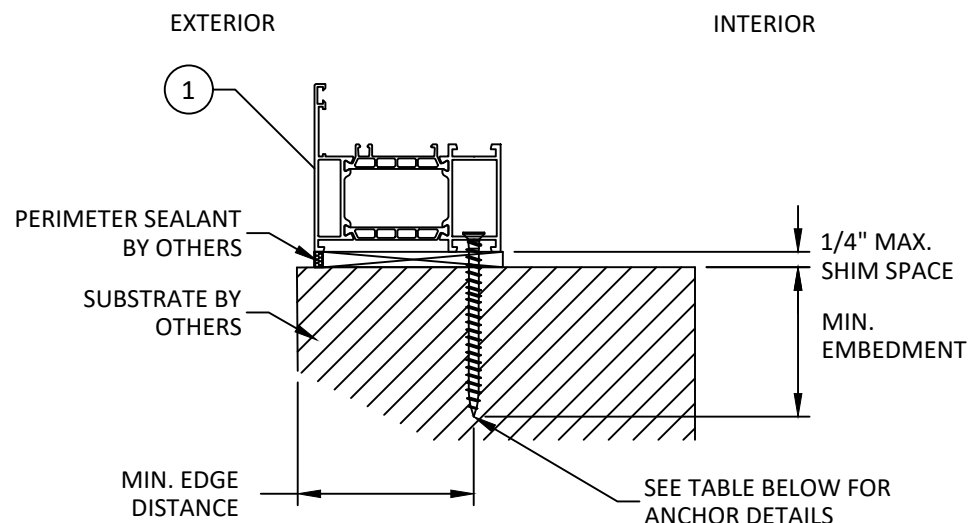

EXTERIOR INTERIOR
B
6 VERTICAL SECTION
 SILL - THROUGH FRAME

NOTE: HEAD & JAMB SIMILAR

INSTALLATION NOTES:

- ONE (1) INSTALLATION ANCHOR IS REQUIRED AT EACH ANCHOR LOCATION SHOWN, UNLESS OTHERWISE STATED ON SHEET 3.
- INSTALL INDIVIDUAL INSTALLATION ANCHORS WITHIN A TOLERANCE OF ±1/2 INCH THE DEPICTED LOCATION & SPACING IN THE ANCHOR LAYOUT DETAILS (I.E., WITHOUT CONSIDERATION OF TOLERANCES). TOLERANCES ARE NOT CUMULATIVE FROM ONE INSTALLATION ANCHOR TO THE NEXT.
- SHIM AS REQUIRED AT EACH INSTALLATION ANCHOR WITH LOAD BEARING SHIM(S). MAXIMUM ALLOWABLE SHIM STACK TO BE 1/4 INCH. SHIM WHERE SPACE OF 1/16 INCH OR GREATER OCCURS. SHIM(S) SHALL BE CONSTRUCTED OF HIGH DENSITY PLASTIC OR BETTER.
- MINIMUM EMBEDMENT AND EDGE DISTANCE EXCLUDE WALL FINISHES, INCLUDING BUT NOT LIMITED TO STUCCO, FOAM, BRICK VENEER, AND SIDING.
- INSTALLATION ANCHORS AND ASSOCIATED HARDWARE MUST BE MADE OF CORROSION RESISTANT MATERIAL OR HAVE A CORROSION RESISTANT COATING.
- FOR MASONRY OR CONCRETE OPENINGS, A 1X WOOD BUCK MAY BE USED (OPTIONAL) AS LONG AS THE MINIMUM EMBEDMENT AND EDGE DISTANCE REQUIREMENTS ARE STILL MET WITHIN THE CORRESPONDING HOST SUBSTRATE. SEE GENERAL NOTE #3 ON SHEET 1 FOR MORE INFORMATION.
- FOR HOLLOW BLOCK AND GROUT FILLED BLOCK, DO NOT INSTALL INSTALLATION ANCHORS INTO MORTAR JOINTS. EDGE DISTANCE IS MEASURED FROM FREE EDGE OF BLOCK OR EDGE OF MORTAR JOINT INTO FACE SHELL OF BLOCK.
- INSTALLATION ANCHORS SHALL BE INSTALLED IN ACCORDANCE WITH ANCHOR MANUFACTURER'S INSTALLATION INSTRUCTIONS, AND ANCHORS SHALL NOT BE USED IN SUBSTRATES WITH STRENGTHS LESS THAN THE MINIMUM STRENGTH SPECIFIED BY THE ANCHOR MANUFACTURER.

ANCHOR SCHEDULE				
METHOD	SUBSTRATE	ANCHOR TYPE	MIN. EMBEDMENT	MIN. EDGE DISTANCE
STRAP	WOOD: MIN. SG = 0.55	#8 WOOD SCREW	1.50"	0.75"
	METAL: 18 GAUGE STEEL, MIN. Fy = 33KSI ALUMINUM: 1/8" MIN., 6063-T5	#8 SELF-DRILLING SCREW	3 THREADS MIN. PENETRATION BEYOND STRUCTURE	0.50"
	CONCRETE: f'c=3000PSI	3/16" ITW TAPCON	1.25"	2.00"
	MASONRY: CMU per ASTM C90 MIN. 2000 PSI	3/16" ITW TAPCON	1.00"	2.00"
THROUGH FRAME	WOOD: MIN. SG = 0.55	#12 WOOD SCREW	1.50"	0.75"
	METAL: 18 GAUGE STEEL, MIN. Fy = 33KSI ALUMINUM: 1/8" MIN., 6063-T5	#12 SELF-DRILLING SCREW	3 THREADS MIN. PENETRATION BEYOND STRUCTURE	0.50"
	CONCRETE: f'c=3000PSI	3/16" ITW TAPCON	1.25"	2.00"
	MASONRY: CMU per ASTM C90 MIN. 2000 PSI	3/16" ITW TAPCON	1.00"	2.00"



LEBORSKA 31, 77-100
 BYTOW, POLAND
 PH: +48-59-822-9101 FX: +48-59-822-9103

TITLE: MB-86N SI
 TILT & TURN WINDOW
 (HVHZ) (IMPACT)
 ANCHOR DETAILS &
 INSTALLATION NOTES

PREPARED BY:
BUILDING DROPS, INC.
 1900 NE MIAMI COURT, STE. 2-15
 MIAMI, FL 33132
 PH: (954) 399-8478
 FAX: (954) 744-4738
 WEB: www.buildingdrops.com



REMARKS	BY	DATE

THE INSTALLATION DETAILS DESCRIBED HEREIN ARE GENERIC AND MAY NOT REFLECT ACTUAL CONDITIONS FOR A SPECIFIC SITE. IF SITE CONDITIONS CAUSE INSTALLATION TO DEVIATE FROM THE REQUIREMENTS DETAILED HEREIN, A LICENSED ENGINEER OR ARCHITECT SHALL PREPARE SITE SPECIFIC DOCUMENTS FOR USE WITH THIS DOCUMENT.

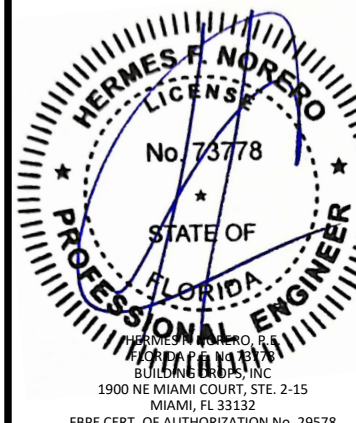

FL #:

FL46728

DATE: **03.19.24**

DWG. BY: **FB** CHK. BY: **HFN**

SCALE: **NTS**

DWG. #: **DRU048**

SHEET:

6

OF 7

5/1/2024 3:52 PM
 c:\users\franciscobreno\building_drops, inc\building_drops, inc\building_drops, inc\projects\drutex, s.a\bc-23-0705.1 - bc_submittal - mb79n.si.mb86n.si.aluminum_systems\dwgs\mb86n\mb86n - &Archiv\drut048.dwg

BILL OF MATERIALS			
ITEM	PART NO.	DESCRIPTION	MATERIAL
1	K528612	FRAME	6063-T5
2	K528712	SASH	6063-T5
3	K431620	GLAZING BEAD	6063-T5
4	-	THERMAL MATERIAL	POLYETHYLENE
5	-	GASKET	EPDM
6	120759	CENTRAL GASKET	EPDM
7	120750	GASKET	EPDM
8	120518	GASKET	EPDM
9	8045502	DRAIN PLUG	PLASTIC
10	-	MACO HARDWARE	STEEL
11	803011040	STRAP	STEEL

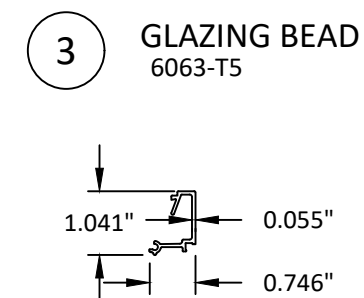
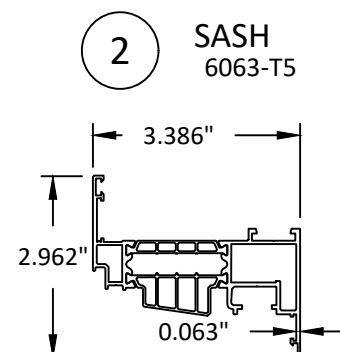
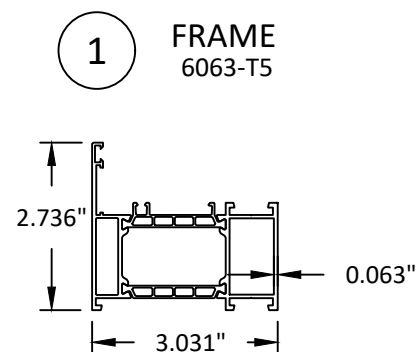

11 STRAP
STEEL

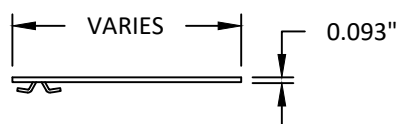

LEBORSKA 31, 77-100
BYTOW, POLAND
PH: +48-59-822-9101 FX: +48-59-822-9103

TITLE: MB-86N SI
TILT & TURN WINDOW
(HYHZ) (IMPACT)
BILL OF MATERIALS
& COMPONENTS

PREPARED BY:
BUILDING DROPS, INC.
1900 NE MIAMI COURT, STE. 2-15
MIAMI, FL 33132
PH: (954) 399-8478
FAX: (954) 744-4738
WEB: www.buildingdrops.com

REMARKS	BY	DATE

THE INSTALLATION DETAILS DESCRIBED HEREIN ARE GENERIC AND MAY NOT REFLECT ACTUAL CONDITIONS FOR A SPECIFIC SITE. IF SITE CONDITIONS CAUSE INSTALLATION TO DEVIATE FROM THE REQUIREMENTS DETAILED HEREIN, A LICENSED ENGINEER OR ARCHITECT SHALL PREPARE SITE SPECIFIC DOCUMENTS FOR USE WITH THIS DOCUMENT.

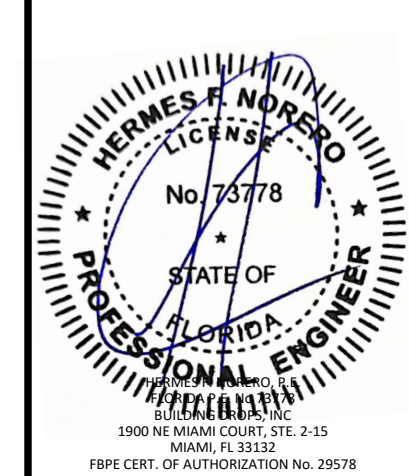

FL #: **FL46728**

DATE: **03.19.24**

DWG. BY: **FB** CHK. BY: **HFN**

SCALE: **NTS**

DWG. #: **DRU048**

SHEET:
7
OF 7